

# BALOGH

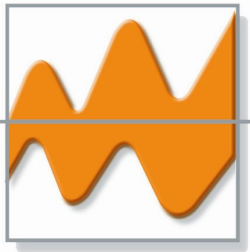

WWW.BALOGHRFID.COM

## BIBS/\*\* INTERBUS-S® Control Interface

**RFID Control Interface**

**Industrial Product Range**



### Key For Tag Suffix

Suffix	Tag Series Description
X	OMX High Speed Industrial R/W Tag Series
E	GIE Industrial R/W Enhanced Speed Tag Series
A	OMA Industrial R/W Tag Series
F	OF Read-Only 7 Byte Industrial Tag Series
L	OLR Long Range 2 Byte Read-Only Industrial Tag
P	OP Light Industrial R/W Tag Series
FC	TAF High Speed R/W Light Industrial Tag Series
IC	TAI Light Industrial R/W Tag Series

### Ordering Information

When assembling your part number, please include the corresponding tag suffix.

**Example:** BIBS/XX. - OMX High Speed Industrial R/W Tag Series. (Cables and Connectors Sold Separately)

### Characteristics

The BIBS-70 is an Interbus-S® Network compatible interface. It has an Identification Code of 241. Configurable as an I/O module, the BIBS-70 is linkable on the Remote Bus of the Interbus-S® Network. The BIBS-70 communicates at 500K baud. Quick Connectors make wiring easier and reduces the cost of installation. Communications are managed by a master (PC or PLC), and requires an Interbus-S® host controller board. The BIBS-70 uses the I/O channel to give status for both channels to the supervisor (16 bits) and the PCP channel to communicate data, requests, and commands. EVENING

#### Features:

- Automatic Self Test on Power up
- Status LED's
- Small Footprint
- Selectable data transfer rates
- Simple Command Set

## Installation Information/Cable Pin Outs

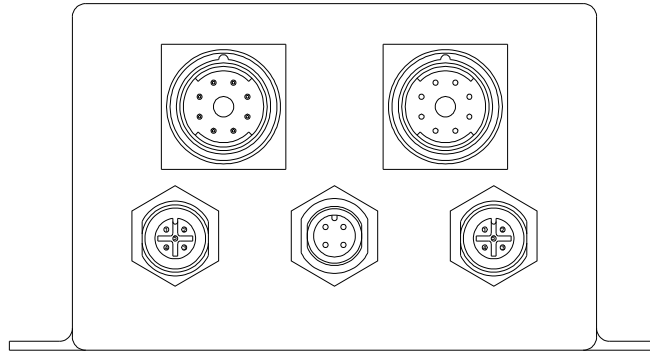

COLOR CODE REFERS TO ONLY BALOGH CABLING

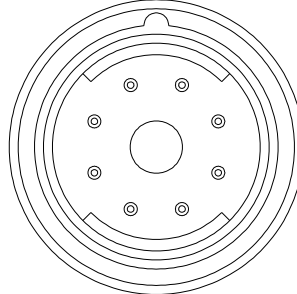

InterBus-S®

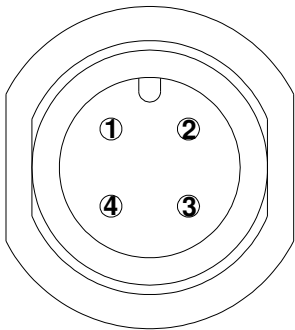

- 1 - +24VDC POWER (BROWN-V)
- 2 - NOT USED
- 3 - NOT USED
- 4 - 0VDC (BLACK-O)

Power: 24 VDC

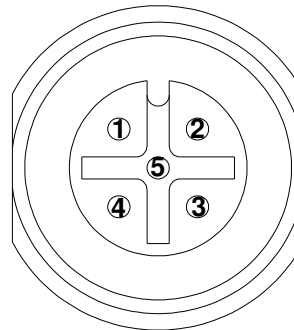

- 1 - +24VDC POWER (BROWN-V)
- 2 - INPUT (WHITE-S)
- 3 - OUTPUT (BLUE-E)
- 4 - 0VDC (BLACK-O)
- 5 - SHIELD

Transceiver Channel 1&2

## Cabling And Accessories (SOLD SEPERATELY)

Network Cable – CONTACT A InterBus-S® CABLE PROVIDER

Transceiver Cable – MF/EXT/\*\* (LENGTHS ARE IN METERS)  
Standard Cable Lengths are 2, 5, 10, 15, 20, 25, 30, 35m

\*\* Indicates Cable Length Please Contact Balogh for other cable lengths.

Only Hand Tighten Cables  
Correct                      Incorrect

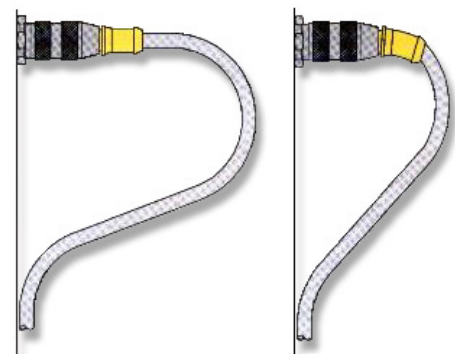

Bend radius 3 x cable diameter

## Technical Information

- 2 Transceiver Channels
- 2 InterBus-S® Connectiona
- Operating Temperature 0° to 50° C
- Weight - 795 Grams
- Requires Regulated 24 VDC (Ripple, 2%)
- Consumes 50 mA of power (without transceivers) 350mA (w/Transcievers)

### BIDN Dip Switches

MSB								Node Address		LSB
1	2	3	4	5	6	7	8			
OFF	OFF	OFF	OFF	OFF	OFF	N/A	N/A	00		
ON	ON	ON	ON	ON	ON	N/A	N/A	63		

MSB						Baud Rate		LSB
N/A	N/A	N/A	N/A	N/A	N/A	OFF	OFF	125
N/A	N/A	N/A	N/A	N/A	N/A	OFF	ON	250
N/A	N/A	N/A	N/A	N/A	N/A	ON	OFF	500

### Status LED'S

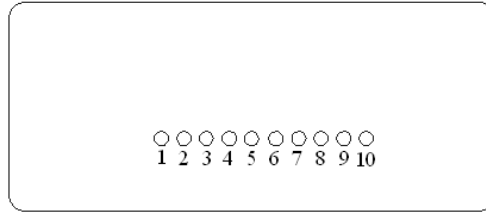

- 1 - MODULE STATUS
- 2 - NETWORK STATUS
- 3 - NOT USED
- 4 - CH2 OP. IN PROGRESS
- 5 - CH2 TAG PRESENT
- 6 - CH2 FAULT
- 7 - CH1 OP. IN PROGRESS
- 8 - CH1 TAG PRESENT
- 9 - CH1 FAULT
- 10 - 24 VDC POWER

Dip Switches/Configuration Port Located Behind LED Cover

## FAQ

# Dimensional Drawing

